

Index to Appendices to Item 4 Report

Appendix	Details	Page No.
Appendix 1	Premises Licence CPBC LU0366 – The Bread and Cheese Variation Application	7
Appendix 2	Existing Premises Licence CPBC LU0366 – The Bread and Cheese	28
Appendix 3	CPBC Environmental Health Representation to Application for a Premises Licence Variation	44
Appendix 4	Resident Representation – Andrew Brown	47
Appendix 5	Aerial View of the Bread and Cheese Licensed Premises and Surrounding Dwellings	48
Appendix 6	Detailed Plan of the Area of the Bread and Cheese and Surrounding Dwellings	49

Application to vary a premises licence under the Licensing Act 2003

PLEASE READ THE FOLLOWING INSTRUCTIONS FIRST

Before completing this form please read the guidance notes at the end of the form. If you are completing this form by hand please write legibly in block capitals. In all cases ensure that your answers are inside the boxes and written in black ink. Use additional sheets if necessary.

You may wish to keep a copy of the completed form for your records.

I/We BREAD & CHEESE (BENFLEET) LIMITED

(Insert name(s) of applicant)

being the premises licence holder, apply to vary a premises licence under section 34 of the Licensing Act 2003 for the premises described in Part 1 below

Premises licence number CPBC/LU/366

Part 1 – Premises Details

Postal address of premises or, if none, ordnance survey map reference or description 520 LONDON ROAD

Post town	BENFLEET	Postcode	SS7 1AA
-----------	----------	----------	---------

Telephone number at premises (if any)	012687534027
---------------------------------------	--------------

Non-domestic rateable value of premises	£72000
---	--------

Part 2 – Applicant details

Daytime contact telephone number	01268330011
----------------------------------	-------------

E-mail address (optional)	JO@AIMPUBS.CO.UK
---------------------------	------------------

Current postal address if different from premises address	17 BRAGANZA WAY
---	-----------------

Post town	CHELMSFORD	Postcode	CM1 6AP
-----------	------------	----------	---------

Part 3 - Variation

Please tick as appropriate

Do you want the proposed variation to have effect as soon as possible?

☒ Yes

☐
No

If not, from what date do you want the variation to take effect?

DD	MM	YYYY
<input type="text"/>	<input type="text"/>	<input type="text"/>

Do you want the proposed variation to have effect in relation to the introduction of the late-night levy? (Please see guidance note 1) ☐ Yes ☒ No

Please briefly describe the nature of the proposed variation (Please see guidance note 2)

To change the opening times so we can serve breakfast and sell alcohol with breakfast - for example champagne breakfasts.

To also shorten closing times which will also help with noise and respect to our neighbours.

To extend the garden timings from April – September to 21.30 as apposes to May this will include Live Music, recorded Music, Dance and Films.

This will support the business as the weather in April tends to be very mild/ warm and it will encourage customers to support the business early evening. Easter and half term also tend to be in April, again encouraging customers to dining and enjoy the early evening warmth outside. We wish to add Films to both internal & external . for example to Show ELF at Christmas time in the garden with the family with hot chocolate, blankets and make it a engaging time and continue to help drive sales throughout the year.

We have removed the outside bar completely as the sale of all drinks including alcohol will be served from inside the building.

All windows to the ground floor have been replaced with slim fixed windows which again will buffer noise from inside.

If your proposed variation would mean that 5,000 or more people are expected to attend the premises at any one time, please state the number expected to attend:

Operating Schedule

Please complete those parts of the Operating Schedule below which would be subject to change if this application to vary is successful.

Provision of regulated entertainment (Please see guidance note 3) **Please tick all that apply**

- | | |
|---|-------------------------------------|
| a) plays (if ticking yes, fill in box A) | <input type="checkbox"/> |
| b) films (if ticking yes, fill in box B) | <input checked="" type="checkbox"/> |
| c) indoor sporting events (if ticking yes, fill in box C) | <input checked="" type="checkbox"/> |
| d) boxing or wrestling entertainment (if ticking yes, fill in box D) | <input type="checkbox"/> |
| e) live music (if ticking yes, fill in box E) | <input checked="" type="checkbox"/> |
| f) recorded music (if ticking yes, fill in box F) | <input checked="" type="checkbox"/> |
| g) performances of dance (if ticking yes, fill in box G) | <input checked="" type="checkbox"/> |
| h) anything of a similar description to that falling within (e), (f) or (g) (if ticking yes, fill in box H) | <input checked="" type="checkbox"/> |

Provision of late night refreshment (if ticking yes, fill in box I) ☒

Supply of alcohol (if ticking yes, fill in box J) ☒

In all cases complete boxes K, L and M

A

Plays Standard days and timings (please read guidance note 8)			<u>Will the performance of a play take place indoors or outdoors or both – please tick (please read guidance note 4)</u>	Indoors	<input type="checkbox"/>
				Outdoors	<input type="checkbox"/>
				Both	<input type="checkbox"/>
Day	Start	Finish	<u>Please give further details here (please read guidance note 5)</u>		
Mon					
Tue					
Wed					
Thur			<u>State any seasonal variations for performing plays (please read guidance note 6)</u>		
Fri					
Sat					
Sun					
			<u>Non standard timings. Where you intend to use the premises for the performance of plays at different times to those listed in the column on the left, please list (please read guidance note 7)</u>		

B

Films Standard days and timings (please read guidance note 8)			Will the exhibition of films take place indoors or outdoors or both – please tick (please read guidance note 4)	Indoors	<input type="checkbox"/>
				Outdoors	<input type="checkbox"/>
				Both	<input checked="" type="checkbox"/>
Day	Start	Finish	Please give further details here (please read guidance note 5)		
Mon	09.00	23.00			
			OUTSIDE TIMINGS FROM - MONDAY – SUNDAY April – September 10.00 – 21.30 October – March 10.00 – 18.00		
Tue	09.00	23.00			
			State any seasonal variations for the exhibition of films (please read guidance note 6)		
Wed	09.00	23.00			
Thur	09.00	23.00			
			Non standard timings. Where you intend to use the premises for the exhibition of films at different times to those listed in the column on the left, please list (please read guidance note 7)		
Fri	09.00	01.00			
Sat	09.00	01.00			
Sun	09.00	23.00			

C

Indoor sporting events Standard days and timings (please read guidance note 8)			<u>Please give further details</u> (please read guidance note 5)
Day	Start	Finish	
Mon	09.00	23.00	
Tue	09.00	23.00	<u>State any seasonal variations for indoor sporting events</u> (please read guidance note 6)
Wed	09.00	23.00	
Thur	09.00	23.00	FOOTBALL & RUGBY & OLYMPICS AND OTHER MAJOR SPORTING EVENTS – EUROS & WORLD CUP FOR BOTH WOMENS & MENS IF IN A TIME ZONE DIFFERENCE TO GMT TO BE ALLOWED
Fri	09.00	01.00	
Sat	09.00	01.00	Non standard timings. Where you intend to use the <u>premises for indoor sporting events at different times to those listed in the column on the left, please list</u> (please read guidance note 7)
Sun	09.00	23.00	

D

Boxing or wrestling entertainments Standard days and timings (please read guidance note 8)			Will the boxing or wrestling entertainment take place indoors or outdoors or both – please tick (please read guidance note 4)	Indoors	<input type="checkbox"/>
				Outdoors	<input type="checkbox"/>
				Both	<input type="checkbox"/>
Day	Start	Finish			
Mon			Please give further details here (please read guidance note 5)		
Tue					
Wed			State any seasonal variations for boxing or wrestling entertainment (please read guidance note 6)		
Thur					
Fri			Non standard timings. Where you intend to use the premises for boxing or wrestling entertainment at different times to those listed in the column on the left, please list (please read guidance note 7).		
Sat					
Sun					

E

Live music Standard days and timings (please read guidance note 8)			Will the performance of live music take place indoors or outdoors or both – please tick (please read guidance note 4)	Indoors	<input type="checkbox"/>
				Outdoors	<input type="checkbox"/>
Day	Start	Finish		Both	<input checked="" type="checkbox"/>
Mon	09.00	23.00	Please give further details here (please read guidance note 5) OUTSIDE TIMINGS FROM - MONDAY – SUNDAY April – September 10.00 – 21.30 October – March 10.00 – 18.00		
Tue	09.00	23.00			
Wed	09.00	23.00	State any seasonal variations for the performance of live music (please read guidance note 6) INSIDE ONLY CHRISTMAS EVE – 01.00 SUNDAY – THURSDAY CHRISTMAS DAY & BOXING DAY – 12.30AM SUNDAY- THURSDAY NEW YEARS EVE 02.00 MONDAY – SUNDAY		
Thur	09.00	23.00			
Fri	09.00	01.00	Non standard timings. Where you intend to use the premises for the performance of live music at different times to those listed in the column on the left, please list (please read guidance note		
Sat	09.00	01.00			
Sun	09.00	23.00	INSIDE ONLY CHRISTMAS EVE – 01.00 SUNDAY – THURSDAY CHRISTMAS DAY & BOXING DAY – 12.30AM SUNDAY- THURSDAY NEW YEARS EVE 02.00 MONDAY – SUNDAY		

30
MIN
EDUCE

F

Recorded music Standard days and timings (please read guidance note 8)			Will the playing of recorded music take place indoors or outdoors or both – please tick (please read guidance note 4)	Indoors	<input type="checkbox"/>
				Outdoors	<input type="checkbox"/>
				Both	<input checked="" type="checkbox"/>
Day	Start	Finish			
Mon	08.00	23.00	Please give further details here (please read guidance note 5) OUTSIDE TIMINGS FROM - MONDAY – SUNDAY April – September 10.00 – 21.30 October – March 10.00 – 18.00		
Tue	08.00	23.00			
Wed	08.00	23.00	State any seasonal variations for the playing of recorded music (please read guidance note 6) INSIDE ONLY CHRISTMAS EVE – 01.00 SUNDAY – THURSDAY CHRISTMAS DAY & BOXING DAY – 12.30AM SUNDAY- THURSDAY NEW YEARS EVE 02.00 MONDAY – SUNDAY		
Thur	08.00	23.00			
Fri	08.00	01.00	Non standard timings. Where you intend to use the premises for the playing of recorded music at different times to those listed in the column on the left, please list (please read guidance note 7)		
Sat	08.00	01.00	INSIDE ONLY CHRISTMAS EVE – 01.00 SUNDAY – THURSDAY CHRISTMAS DAY & BOXING DAY – 12.30AM SUNDAY- THURSDAY NEW YEARS EVE 02.00 MONDAY – SUNDAY		
Sun	08.00	23.00			

G

Performances of dance Standard days and timings (please read guidance note 8)			<u>Will the performance of dance take place indoors or outdoors or both – please tick</u> (please read guidance note 4)	Indoors	<input type="checkbox"/>
				Outdoors	<input type="checkbox"/>
				Both	<input checked="" type="checkbox"/>
Day	Start	Finish			
Mon	09.00	23.00	<u>Please give further details here</u> (please read guidance note 5) OUTSIDE TIMINGS FROM - MONDAY – SUNDAY April – September 10.00 – 21.30 October – March 10.00 – 18.00		
Tue	09.00	23.00			
Wed	09.00	23.00	<u>State any seasonal variations for the performance of dance</u> (please read guidance note 6) INSIDE ONLY CHRISTMAS EVE – 01.00 SUNDAY – THURSDAY CHRISTMAS DAY & BOXING DAY – 12.30AM SUNDAY-THURSDAY NEW YEARS EVE 02.00 MONDAY – SUNDAY		
Thur	09.00	23.00			
Fri	09.00	01.00	<u>Non standard timings. Where you intend to use the premises for the performance of dance at different times to those listed in the column on the left, please list</u> (please read guidance note 7)		
Sat	09.00	01.00			
Sun	09.00	23.00	CHRISTMAS DAY & BOXING DAY – 12.30AM SUNDAY-THURSDAY NEW YEARS EVE 02.00 MONDAY – SUNDAY		

H

Anything of a similar description to that falling within (e), (f) or (g) Standard days and timings (please read guidance note 8)			Please give a description of the type of entertainment you will be providing QUIZ, RACE NIGHT, CHARITY EVENTS		
Day	Start	Finish	<u>Will this entertainment take place indoors or outdoors or both – please tick</u> (please read guidance note 4)	Indoors	<input type="checkbox"/>
Mon	09.00	23.00		Outdoors	<input type="checkbox"/>
				Both	<input checked="" type="checkbox"/>
Tue	09.00	23.00	<u>Please give further details here</u> (please read guidance note 5) OUTSIDE TIMINGS FROM - MONDAY – SUNDAY April – September 10.00 – 21.30 October – March 10.00 – 18.00		
Wed	09.00	23.00			
Thur	09.00	23.00	<u>State any seasonal variations for entertainment of a similar description to that falling within (e), (f) or (g)</u> (please read guidance note 6) INSIDE ONLY CHRISTMAS EVE – 01.00 SUNDAY – THURSDAY CHRISTMAS DAY & BOXING DAY – 12.30AM SUNDAY-THURSDAY NEW YEARS EVE 02.00 MONDAY – SUNDAY		
Fri	09.00	01.00			
Sat	09.00	01.00	<u>Non standard timings. Where you intend to use the premises for the entertainment of a similar description to that falling within (e), (f) or (g) at different times to those listed in the column on the left, please list</u> (please read guidance note 7) INSIDE ONLY CHRISTMAS EVE – 01.00 SUNDAY – THURSDAY CHRISTMAS DAY & BOXING DAY – 12.30AM SUNDAY-THURSDAY NEW YEARS EVE 02.00 MONDAY - SUNDAY		
Sun	09.00	23.00			

I

Late night refreshment Standard days and timings (please read guidance note 8)			Will the provision of late night refreshment take place indoors or outdoors or both – please tick (please read guidance note 4)	Indoors <input checked="" type="checkbox"/>
				Outdoors <input type="checkbox"/>
Day	Start	Finish		Both <input type="checkbox"/>
Mon	23.00	23.30	Please give further details here (please read guidance note 5)	
Tue	23.00	23.30		
Wed	23.00	23.30	State any seasonal variations for the provision of late night refreshment (please read guidance note 6) INSIDE ONLY CHRISTMAS EVE – 01.00 SUNDAY – THURSDAY CHRISTMAS DAY & BOXING DAY – 12.30AM SUNDAY-THURSDAY NEW YEARS EVE 02.00 MONDAY – SUNDAY	
Thur	23.00	23.30		
Fri	23.00	01.30	Non standard timings. Where you intend to use the premises for the provision of late night refreshment at different times, to those listed in the column on the left, please list (please read guidance note 7) INSIDE ONLY CHRISTMAS EVE – 01.00 SUNDAY – THURSDAY CHRISTMAS DAY & BOXING DAY – 12.30AM SUNDAY-THURSDAY NEW YEARS EVE 02.00 MONDAY - SUNDAY	
Sat	23.00	01.30		
Sun	23.00	23.30		

J

Supply of alcohol Standard days and timings (please read guidance note 8)			Will the supply of alcohol be for consumption – please tick (please read guidance note 9)	On the premises	<input type="checkbox"/>
				Off the premises	<input type="checkbox"/>
				Both	<input checked="" type="checkbox"/>
Day	Start	Finish	State any seasonal variations for the supply of alcohol (please read guidance note 6)		
Mon	08.00	23.00			
Tue	08.00	23.00			
Wed	08.00	23.00			
Thur	08.00	23.00	Non-standard timings. Where you intend to use the premises for the supply of alcohol at different times to those listed in the column on the left, please list (please read guidance note 7)		
Fri	08.00	01.00			
Sat	08.00	01.00			
Sun	08.00	23.00			

INSIDE ONLY
CHRISTMAS EVE – 01.00 SUNDAY – THURSDAY
CHRISTMAS DAY & BOXING DAY – 12.30AM SUNDAY-THURSDAY
NEW YEARS EVE 02.00 MONDAY - SUNDAY

INSIDE ONLY
CHRISTMAS EVE – 01.00 SUNDAY – THURSDAY
CHRISTMAS DAY & BOXING DAY – 12.30AM SUNDAY-THURSDAY
NEW YEARS EVE 02.00 MONDAY – SUNDAY

K

<p>Please highlight any adult entertainment or services, activities, other entertainment or matters ancillary to the use of the premises that may give rise to concern in respect of children (please read guidance note 10).</p>
--

L

Hours premises are open to the public Standard days and timings (please read guidance note 8)			State any seasonal variations (please read guidance note 6)
Day	Start	Finish	
Mon	08.00	23.30	INSIDE ONLY CHRISTMAS EVE – 01.00 SUNDAY – THURSDAY CHRISTMAS DAY & BOXING DAY – 12.30AM SUNDAY-THURSDAY NEW YEARS EVE 02.00 MONDAY – SUNDAY
Tue	08.00	23.30	
Wed	08.00	23.30	
Thur	08.00	23.30	
Fri	08.00	01.00	<u>Non standard timings. Where you intend the premises to be open to the public at different times from those listed in the column on the left, please list</u> (please read guidance note 7) INSIDE ONLY CHRISTMAS EVE – 01.00 SUNDAY – THURSDAY CHRISTMAS DAY & BOXING DAY – 12.30AM SUNDAY-THURSDAY NEW YEARS EVE 02.00 MONDAY – SUNDAY
Sat	08.00	01.00	
Sun	08.00	23.30	

Please identify those conditions currently imposed on the licence which you believe could be removed as a consequence of the proposed variation you are seeking.

Please tick as appropriate

- I have enclosed the premises licence
- I have enclosed the relevant part of the premises licence

☒
☐

If you have not ticked one of these boxes, please fill in reasons for not including the licence or part of it below

Reasons why I have not enclosed the premises licence or relevant part of premises licence.

N/A

M Describe any additional steps you intend to take to promote the four licensing objectives as a result of the proposed variation:

a) General – all four licensing objectives (b, c, d and e) (please read guidance note 11)

EVERYTHING ON THE CURRENT PREMISE LICENSE TO STAND
CCTV IS OPERATIONAL INSIDE & OUTSIDE
CHALLENGE 25 WILL BE OBSERVED

b) The prevention of crime and disorder

EVERYTHING ON THE CURRENT PREMISE LICENSE TO STAND
CCTV IS OPERATIONAL INSIDE & OUTSIDE
CHALLENGE 25 WILL BE OBSERVED

c) Public safety

EVERYTHING ON THE CURRENT PREMISE LICENSE TO STAND
CCTV IS OPERATIONAL INSIDE & OUTSIDE
CHALLENGE 25 WILL BE OBSERVED

d) The prevention of public nuisance

EVERYTHING ON THE CURRENT PREMISE LICENSE TO STAND
CCTV IS OPERATIONAL INSIDE & OUTSIDE
CHALLENGE 25 WILL BE OBSERVED

e) The protection of children from harm

EVERYTHING ON THE CURRENT PREMISE LICENSE TO STAND
CCTV IS OPERATIONAL INSIDE & OUTSIDE
CHALLENGE 25 WILL BE OBSERVED

Checklist:

Please tick to indicate agreement

- I have made or enclosed payment of the fee; or ☒
- I have not made or enclosed payment of the fee because this application has been made in relation to the introduction of the late night levy. ☐
- I have sent copies of this application and the plan to responsible authorities and others where applicable. ☒
- I understand that I must now advertise my application. ☒
- I have enclosed the premises licence or relevant part of it or explanation. ☒
- I understand that if I do not comply with the above requirements my application will be rejected. ☒

IT IS AN OFFENCE, UNDER SECTION 158 OF THE LICENSING ACT 2003, TO MAKE A FALSE STATEMENT IN OR IN CONNECTION WITH THIS APPLICATION. THOSE WHO MAKE A FALSE STATEMENT MAY BE LIABLE ON SUMMARY CONVICTION TO A FINE OF ANY AMOUNT.

Part 5 – Signatures (please read guidance note 12)

Signature of applicant (the current premises licence holder) or applicant's solicitor or other duly authorised agent (please read guidance note 13). **If signing on behalf of the applicant, please state in what capacity.**

Signature	
Date	15.03.24
Capacity	FINANCE DIRECTOR

Where the premises licence is jointly held, signature of 2nd applicant (the current premises licence holder) or 2nd applicant's solicitor or other authorised agent (please read guidance note 14). **If signing on behalf of the applicant, please state in what capacity.**

Signature	
Date	
Capacity	

Contact name (where not previously given) and address for correspondence associated with this application (please read guidance note 15)
MRS JO HASLAM
17 BRAGANZA WAY

Post town	CHELMSFORD	Post code	CM1 6AP
Telephone number (if any)	01268330011 OR 07958209480		

If you would prefer us to correspond with you by e-mail, your e-mail address (optional)
JO@AIMPUBS.CO.UK

Notes for Guidance

This application cannot be used to vary the licence so as to extend the period for which the licence has effect or to vary substantially the premises to which it relates. If you wish to make that type of change to the premises licence, you should make a new premises licence application under section 17 of the Licensing Act 2003.

1. You do not have to pay a fee if the only purpose of the variation for which you are applying is to avoid becoming liable for the late night levy
2. Describe the premises. For example, the type of premises, its general situation and layout and any other information which could be relevant to the licensing objectives. Where your application includes off-supplies of alcohol and you intend to provide a place of consumption of these off-supplies of alcohol, you must include a description of where the place will be and its proximity to the premises.
3. In terms of specific regulated entertainments please note that:
 - Plays: no licence is required for performances between 08.00 and 23.00 on any day, provided that the audience does not exceed 500.
 - Films: no licence is required for 'not-for-profit' film exhibition held in community premises between 08.00 and 23.00 on any day provided that the audience does not exceed 500 and the organiser (a) gets consent to the screening from a person who is responsible for the premises; and (b) ensures that each such screening abides by age classification ratings.
 - Indoor sporting events: no licence is required for performances between 08.00 and 23.00 on any day, provided that the audience does not exceed 1000.
 - Boxing or Wrestling Entertainment: no licence is required for a contest, exhibition or display of Greco-Roman wrestling, or freestyle wrestling between 08.00 and 23.00 on any day, provided that the audience does not exceed 1000. Combined fighting sports – defined as a contest, exhibition or display which combines boxing or wrestling with one or more martial arts – are licensable as a boxing or wrestling entertainment rather than an indoor sporting event.
 - Live music: no licence permission is required for:
 - a performance of unamplified live music between 08.00 and 23.00 on any day, on any premises.
 - a performance of amplified live music between 08.00 and 23.00 on any day on premises authorised to sell alcohol for consumption on those premises, provided that the audience does not exceed 500.
 - a performance of amplified live music between 08.00 and 23.00 on any day, in a workplace that is not licensed to sell alcohol on those premises, provided that the audience does not exceed 500.
 - a performance of amplified live music between 08.00 and 23.00 on any day, in a church hall, village hall, community hall, or other similar community premises, that is not licensed by a premises licence to sell alcohol, provided that (a) the audience does not exceed 500, and (b) the organiser gets consent for the performance from a person who is responsible for the premises.
 - a performance of amplified live music between 08.00 and 23.00 on any day, at the non-residential premises of (i) a local authority, or (ii) a school, or (iii) a hospital, provided that (a) the audience does not exceed 500, and (b) the organiser gets consent for the performance on the relevant premises from: (i) the local authority concerned, or (ii) the school or (iii) the health care provider for the hospital.

- Recorded Music: no licence permission is required for:
 - any playing of recorded music between 08.00 and 23.00 on any day on premises authorised to sell alcohol for consumption on those premises, provided that the audience does not exceed 500.
 - any playing of recorded music between 08.00 and 23.00 on any day, in a church hall, village hall, community hall, or other similar community premises, that is not licensed by a premises licence to sell alcohol, provided that (a) the audience does not exceed 500, and (b) the organiser gets consent for the performance from a person who is responsible for the premises.
 - any playing of recorded music between 08.00 and 23.00 on any day, at the non-residential premises of (i) a local authority, or (ii) a school, or (iii) a hospital, provided that (a) the audience does not exceed 500, and (b) the organiser gets consent for the performance on the relevant premises from: (i) the local authority concerned, or (ii) the school proprietor or (iii) the health care provider for the hospital.
 - Dance: no licence is required for performances between 08.00 and 23.00 on any day, provided that the audience does not exceed 500. However, a performance which amounts to adult entertainment remains licensable.
 - Cross activity exemptions: no licence is required between 08.00 and 23.00 on any day, with no limit on audience size for:
 - any entertainment taking place on the premises of the local authority where the entertainment is provided by or on behalf of the local authority;
 - any entertainment taking place on the hospital premises of the health care provider where the entertainment is provided by or on behalf of the health care provider;
 - any entertainment taking place on the premises of the school where the entertainment is provided by or on behalf of the school proprietor; and
 - any entertainment (excluding films and a boxing or wrestling entertainment) taking place at a travelling circus, provided that (a) it takes place within a moveable structure that accommodates the audience, and (b) that the travelling circus has not been located on the same site for more than 28 consecutive days.
4. Where taking place in a building or other structure please tick as appropriate (indoors may include a tent).
 5. For example state type of activity to be authorised, if not already stated, and give relevant further details, for example (but not exclusively) whether or not music will be amplified or unamplified.
 6. For example (but not exclusively), where the activity will occur on additional days during the summer months.
 7. For example (but not exclusively), where you wish the activity to go on longer on a particular day e.g. Christmas Eve.
 8. Please give timings in 24 hour clock (e.g. 16.00) and only give details for the days of the week when you intend the premises to be used for the activity.
 9. If you wish people to be able to consume alcohol on the premises, please tick 'on the premises'. If you wish people to be able to purchase alcohol to consume away from the premises, please tick 'off the premises'. If you wish people to be able to do both, please tick 'both'.
 10. Please give information about anything intended to occur at the premises or ancillary to the use of the premises which may give rise to concern in respect of children regardless of whether you intend children to have access to the premises, for example (but not exclusively) nudity or semi-nudity, films for restricted age groups or the presence of gaming machines.
 11. Please list here steps you will take to promote all four licensing objectives together.

12. The application form must be signed.
13. An applicant's agent (for example solicitor) may sign the form on their behalf provided that they have actual authority to do so.
14. Where there is more than one applicant, each of the applicants or their respective agents must sign the application form.
15. This is the address which we shall use to correspond with you about this application.

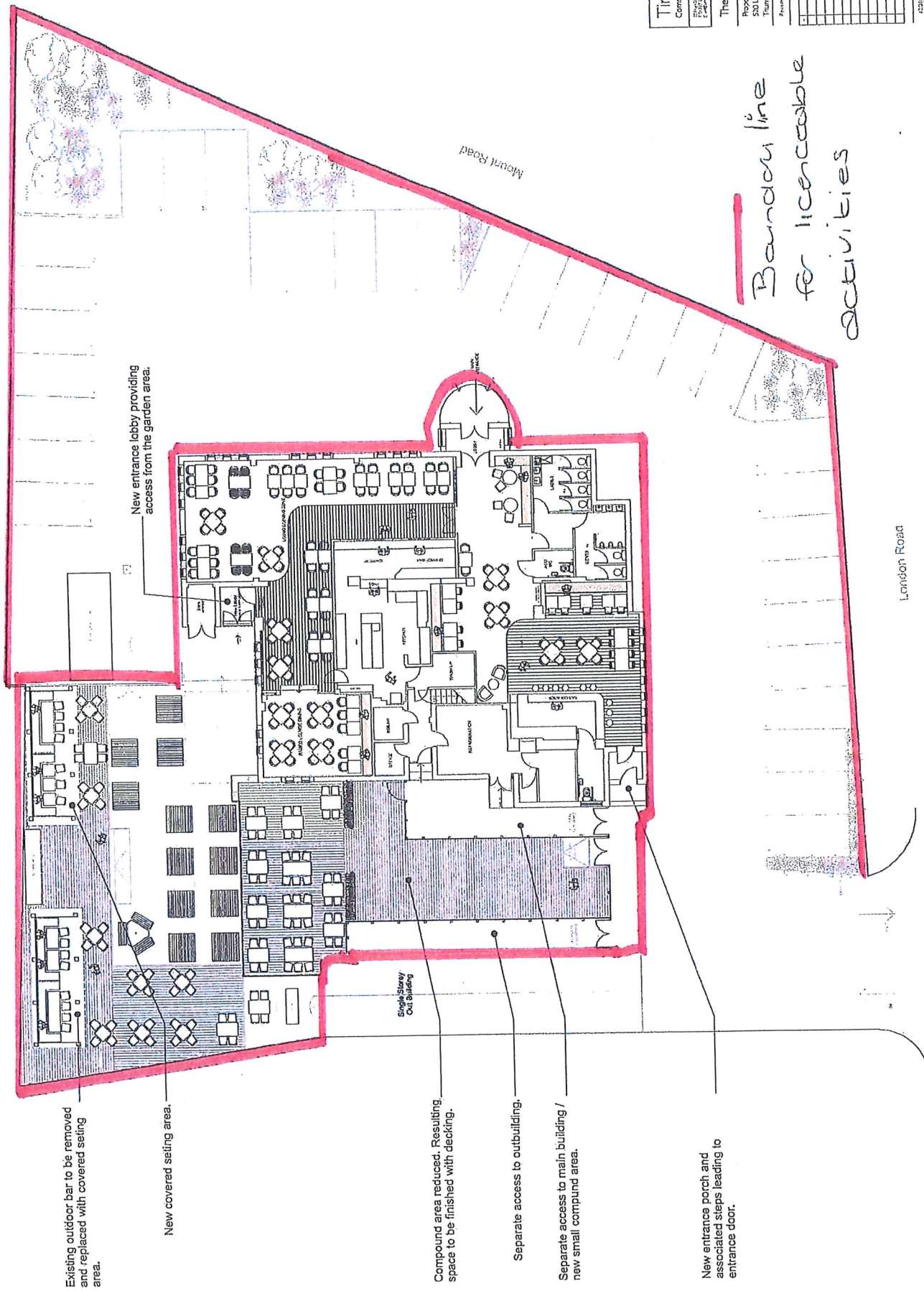

New entrance porch and associated steps leading to entrance door.

New entrance lobby providing access from the garden area.

Single Story

Mount Road

London Road

Bandwidth for licenceable activities

Tim Marshall Design
Commercial Interior Design Consultancy

2119 Oaklawn, Suite 2012A
Fort Worth, TX 76104-1214
E: tim@timmarshall.com
F: [817-335-1111](tel:817-335-1111)

The Bread & Cheese

Proposed Site Plan
520 Leiden Road, Benfleet
Thamesley SS17 1AA

Al			
Zeolom			

[illegible]

REF ID	SCALE	DATE	REMARK
1001	100	10/10/00	
1002	100	10/10/00	
1003	100	10/10/00	
1004	100	10/10/00	
1005	100	10/10/00	
1006	100	10/10/00	
1007	100	10/10/00	
1008	100	10/10/00	
1009	100	10/10/00	
1010	100	10/10/00	
1011	100	10/10/00	
1012	100	10/10/00	
1013	100	10/10/00	
1014	100	10/10/00	
1015	100	10/10/00	
1016	100	10/10/00	
1017	100	10/10/00	
1018	100	10/10/00	
1019	100	10/10/00	
1020	100	10/10/00	
1021	100	10/10/00	
1022	100	10/10/00	
1023	100	10/10/00	
1024	100	10/10/00	
1025	100	10/10/00	
1026	100	10/10/00	
1027	100	10/10/00	
1028	100	10/10/00	
1029	100	10/10/00	
1030	100	10/10/00	
1031	100	10/10/00	
1032	100	10/10/00	
1033	100	10/10/00	
1034	100	10/10/00	
1035	100	10/10/00	
1036	100	10/10/00	
1037	100	10/10/00	
1038	100	10/10/00	
1039	100	10/10/00	
1040	100	10/10/00	
1041	100	10/10/00	
1042	100	10/10/00	
1043	100	10/10/00	
1044	100	10/10/00	
1045	100	10/10/00	
1046	100	10/10/00	
1047	100	10/10/00	
1048	100	10/10/00	
1049	100	10/10/00	
1050	100	10/10/00	
1051	100	10/10/00	
1052	100	10/10/00	
1053	100	10/10/00	
1054	100	10/10/00	
1055	100	10/10/00	
1056	100	10/10/00	
1057	100	10/10/00	
1058	100	10/10/00	
1059	100	10/10/00	
1060	100	10/10/00	
1061	100	10/10/00	
1062	100	10/10/00	
1063	100	10/10/00	
1064	100	10/10/00	
1065	100	10/10/00	
1066	100	10/10/00	
1067	100	10/10/00	
1068	100	10/10/00	
1069	100	10/10/00	
1070	100	10/10/00	
1071	100	10/10/00	
1072	100	10/10/00	
1073	100	10/10/00	
1074	100	10/10/00	
1075	100	10/10/00	
1076	100	10/10/00	
1077	100	10/10/00	
1078	100	10/10/00	
1079	100	10/10/00	
1080	100	10/10/00	
1081	100	10/10/00	
1082	100	10/10/00	
1083	100	10/10/00	
1084	100	10/10/00	
1085	100	10/10/00	
1086	100	10/10/00	
1087	100	10/10/00	
1088	100	10/10/00	
1089	100	10/10/00	
1090	100	10/10/00	</

[illegible]

Site Plan
Scale 1:100

Licensing Act 2003 Premises Licence

CPBC/LU/366

LOCAL AUTHORITY



Licensing Department
Castle Point Borough Council
 Council Offices, Kiln Road,
 Thundersley, Benfleet,
 Essex SS7 1TF
 Tel: 01268 882200

Part 1 - Premises Details

POSTAL ADDRESS OF PREMISES, OR IF NONE, ORDNANCE SURVEY MAP REFERENCE OR DESCRIPTION

BREAD AND CHEESE

520 LONDON ROAD, BENFLEET, ESSEX, SS7 1AA.

Telephone 01268 753402 or 07979 187558 (Kate)

WHERE THE LICENCE IS TIME LIMITED THE DATES

Not applicable

LICENSABLE ACTIVITIES AUTHORISED BY THE LICENCE

- an exhibition of a film
- a performance of live music
- any playing of recorded music
- a performance of dance
- entertainment facilities for making music
- entertainment facilities for dancing
- entertainment of a similar description to that falling within entertainment facilities for making music or dancing
- provision of late night refreshment
- the sale by retail of alcohol

THE TIMES THE LICENCE AUTHORISES THE CARRYING OUT OF LICENSABLE ACTIVITIES

Activity (and Area if applicable)	Description	Time From	Time To
B. Exhibition of films (Indoors)	Monday to Thursday	11:00am	11:30pm
	Friday and Saturday	11:00am	1:00am
	Sunday	11:00am	11:00pm
	Bank Holiday	12:00pm	12:30am
	Christmas Day	11:00am	12:30am
	Boxing Day	11:00am	12:30am
	New Years Eve	11:00am	3:30am
E. Performance of live music (Indoors & Outdoors)	Bank Holiday	8:00pm	11:00pm
	Sunday	11:00am	11:00pm
	Monday to Thursday	11:00am	11:30pm
	Christmas Eve	8:00pm	Midnight
	Boxing Day	8:00pm	Midnight



THE TIMES THE LICENCE AUTHORISES THE CARRYING OUT OF LICENSABLE ACTIVITIES continued ...

Activity (and Area if applicable)	Description	Time From	Time To
E. Performance of live music (Indoors & Outdoors) continued ...	Friday and Saturday	11:00am	1:00am
	New Years Eve	8:00pm	2:00am
	Monday to Sunday	11:00am	11:00pm
	Garden		
F. Playing of recorded music (Indoors & Outdoors)	Sunday	11:00am	11:00pm
	Indoors		
	Bank Holiday	8:00pm	11:00pm
	Indoors		
	Christmas Eve	8:00pm	Midnight
	Indoors		
	Monday to Thursday	11:00am	11:30pm
	Indoors		
	Friday and Saturday	11:00am	1:00am
	Indoors		
	Boxing Day	8:00pm	Midnight
	Indoors		
	New Years Eve	8:00pm	2:00am
	Indoors		
	Monday to Sunday	11:00am	11:00pm
	Garden		
G. Performance of dance (Indoors & Outdoors)	Sunday	11:00am	11:00pm
	Indoors		
	Bank Holiday	8:00pm	11:00pm
	Indoors		
	Christmas Eve	8:00pm	Midnight
	Indoors		
	Monday to Thursday	11:00am	11:30pm
	Indoors		
	Friday and Saturday	11:00am	1:00am
	Indoors		
	Boxing Day	8:00pm	Midnight
	Indoors		
	New Years Eve	8:00pm	2:00am
	Indoors		
	Monday to Sunday	11:00am	11:00pm
	Garden		
I. Provision of facilities for making music (Indoors & Outdoors)	Sunday	11:00am	11:00pm
	Indoors		
	Bank Holiday	8:00pm	11:00pm
	Indoors		
	Christmas Eve	8:00pm	Midnight
	Indoors		
	Monday to Thursday	11:00am	11:30pm
	Indoors		
	Friday and Saturday	11:00am	1:00am
	Indoors		
	Boxing Day	8:00pm	Midnight
	Indoors		
	New Years Eve	8:00pm	2:00am

THE TIMES THE LICENCE AUTHORISES THE CARRYING OUT OF LICENSABLE ACTIVITIES continued ...

Activity (and Area if applicable)	Description	Time From	Time To
I. Provision of facilities for making music (Indoors & Outdoors) continued ...			
	Indoors		
	Monday to Sunday	11:00am	11:00pm
	Garden		
J. Provision of facilities for dancing (Indoors & Outdoors)			
	Sunday	11:00am	11:00pm
	Indoors		
	Bank Holiday	8:00pm	11:00pm
	Indoors		
	Christmas Eve	8:00pm	Midnight
	Indoors		
	Monday to Thursday	11:00am	11:30pm
	Indoors		
	Friday and Saturday	11:00am	1:00am
	Indoors		
	Boxing Day	8:00pm	Midnight
	Indoors		
	New Years Eve	8:00pm	2:00am
	Indoors		
	Monday to Sunday	11:00am	11:00pm
K. Provision of facilities for entertainment of a similar description to that falling within I or J (Indoors)			
	Friday and Saturday	11:00am	1:00am
	Thursday	8:00pm	11:00pm
	Christmas Eve	8:00pm	Midnight
	Boxing Day	8:00pm	Midnight
	New Years Eve	8:00pm	2:00am
	Bank Holiday	8:00pm	11:00pm
	Monday to Sunday	11:00am	11:00pm
	Garden		
L. Late night refreshment (Indoors)			
	Monday to Thursday	11:00pm	11:30pm
	Friday and Saturday	11:00pm	1:00am
	Monday to Sunday	11:00am	11:00pm
	Garden		
M. The sale by retail of alcohol for consumption ON and OFF the premises			
	Monday to Thursday	11:00am	11:00pm
	Bank Holiday	Noon	Midnight
	Monday to Sunday	11:00am	9:30pm
	Garden (21.30 May to September only - All other months 18.00)		
	Friday and Saturday	11:00am	12:30am
	Sunday	11:00am	11:00pm
	Christmas Eve	11:00am	Midnight
	Boxing Day	11:00am	Midnight
	New Years Eve	11:00am	3:00am

THE OPENING HOURS OF THE PREMISES

Description	Time From	Time To
Monday to Thursday	11:00am	11:30pm
Friday and Saturday	11:00am	1:00am
Sunday	11:00am	11:00pm
Bank Holiday	Noon	12:30am
Christmas Day	11:00am	12:30am
Boxing Day	11:00am	12:30am
New Years Eve	11:00am	3:30am

WHERE THE LICENCE AUTHORISES SUPPLIES OF ALCOHOL WHETHER THESE ARE ON AND / OR OFF SUPPLIES

- M. The sale by retail of alcohol for consumption ON and OFF the premises

Licensing Act 2003
Premises Licence

CPBC/LU/366

Part 2

NAME, (REGISTERED) ADDRESS, TELEPHONE NUMBER AND EMAIL (WHERE RELEVANT) OF HOLDER OF PREMISES LICENCE

BREAD AND CHEESE (BENFLEET) LTD
304 HIGH ROAD, BENFLEET, ESSEX, SS7 5HB.
Telephone 07958209480

REGISTERED NUMBER OF HOLDER, FOR EXAMPLE COMPANY NUMBER, CHARITY NUMBER (WHERE APPLICABLE)

NAME, ADDRESS AND TELEPHONE NUMBER OF DESIGNATED PREMISES SUPERVISOR WHERE THE PREMISES LICENCE
AUTHORISES THE SUPPLY OF ALCOHOL

JOANNE HASLAM 17 Braganza Way, Beaulieu Park, CHELMSFORD, ESSEX, CM1 1JE.

PERSONAL LICENCE NUMBER AND ISSUING AUTHORITY OF PERSONAL LICENCE HELD BY DESIGNATED PREMISES SUPERVISOR
WHERE THE PREMISES LICENCE AUTHORISES FOR THE SUPPLY OF ALCOHOL

Licence No. 06/00173

Issued by



ANNEXES**ANNEX 1 - MANDATORY CONDITIONS****MANDATORY LICENSING CONDITIONS**

NO SALE OF ALCOHOL MAY BE MADE UNDER THE PREMISES LICENCE:

A) AT A TIME WHEN THERE IS NO DESIGNATED PREMISES SUPERVISOR IN RESPECT OF THE PREMISES LICENCE; OR

B) AT A TIME WHEN THE DESIGNATED PREMISES SUPERVISOR DOES NOT HOLD A PERSONAL LICENCE OR HIS PERSONAL LICENCE IS SUSPENDED.

EVERY SUPPLY OF ALCOHOL UNDER THE PREMISES LICENCE MUST BE MADE OR AUTHORISED BY A PERSON WHO HOLDS A PERSONAL LICENCE.

MANDATORY LICENSING CONDITIONS

1) The responsible person must ensure that staff on relevant premises do not carry out, arrange or participate in any irresponsible promotions in relation to the premises.

(2) In this paragraph, an irresponsible promotion means any one or more of the following activities, or substantially similar activities, carried on for the purpose of encouraging the sale or supply of alcohol for consumption on the premises-

(a) games or other activities which require or encourage, or are designed to require or encourage, individuals to -

(i) drink a quantity of alcohol within a time limit (other than to drink alcohol sold or supplied on the premises before the cessation of the period in which the responsible person is authorised to sell or supply alcohol), or

(ii) drink as much alcohol as possible (whether within a time limit or otherwise);

(b) provision of unlimited or unspecified quantities of alcohol free or for a fixed or discounted fee to the public or to a group defined by a particular characteristic in a manner which carries a significant risk of undermining a licensing objective;

(c) provision of free or discounted alcohol or any other thing as a prize to encourage or reward the purchase and consumption of alcohol over a period of 24 hours or less in a manner which carries a significant risk of undermining a licensing objective;

(d) selling or supplying alcohol in association with promotional posters or flyers on, or in the vicinity of, the premises which can reasonably be considered to condone, encourage or

ANNEXES continued ...

glamorise anti-social behaviour or to refer to the effects of drunkenness in any favourable manner;

(e) dispensing alcohol directly by one person into the mouth of another (other than where that other person is unable to drink without assistance by reason of disability).

2). The responsible person must ensure that free potable water is provided on request to customers where it is reasonably available.

3. (1) The premises licence holder or club premises certificate holder must ensure that an age verification policy is adopted in respect of the premises in relation to the sale or supply of alcohol.

(2) The designated premises supervisor in relation to the premises licence must ensure that the supply of alcohol at the premises is carried on in accordance with the age verification policy.

(3) The policy must require individuals who appear to the responsible person to be under 18 years of age (or such older age as may be specified in the policy) to produce on request, before being served alcohol, identification bearing their photograph, date of birth and either-

(a) a holographic mark, or

(b) an ultraviolet feature.

4. The responsible person must ensure that-

(a) where any of the following alcoholic drinks is sold or supplied for consumption on the premises (other than alcoholic drinks sold or supplied having been made up in advance ready for sale or supply in a securely closed container) it is available to customers in the following measures-

(i) beer or cider: ½ pint;

(ii) gin, rum, vodka or whisky: 25 ml or 35 ml; and

(iii) still wine in a glass: 125 ml; and

(b) these measures are displayed in a menu, price list or other printed material which is available to customers on the premises; and

(c) where a customer does not in relation to a sale of alcohol specify the quantity of alcohol to be sold, the customer is made aware that these measures are available.

1. A relevant person shall ensure that no alcohol is sold or supplied for consumption on or off

ANNEXES continued ...

the premises for a price which is less than the permitted price.

2. For the purposes of the condition set out in paragraph 1-

(a) "duty" is to be construed in accordance with the Alcoholic Liquor Duties Act 1979(a);

(b) "permitted price" is the price found by applying the formula-

$$P = D + (D \times V)$$

where-

(i) P is the permitted price,

(ii) D is the rate of duty chargeable in relation to the alcohol as if the duty were charged on the date of the sale or supply of the alcohol, and

(iii) V is the rate of value added tax chargeable in relation to the alcohol as if the value added tax were charged on the date of the sale or supply of the alcohol;

(c) "relevant person" means, in relation to premises in respect of which there is in force a premises licence-

(i) the holder of the premises licence,

(ii) the designated premises supervisor (if any) in respect of such a licence

or

(iii) The personal licence holder who makes or authorises a supply of alcohol under such a licence;

(d) "relevant person" means, in relation to premises in respect of which there is in force a club premises certificate, any member or officer of the club present on the premises in a capacity which enables the member or officer to prevent the supply in question; and

(e) "value added tax" means value added tax charged in accordance with the Value Added Tax Act 1994(b)

3. Where the permitted price given by Paragraph (b) of paragraph 2 would (apart from this paragraph) not be a whole number of pennies, the price given by that sub-paragraph shall be taken to be the price actually given by that sub-paragraph rounded up to the nearest penny.

4. (1) Sub-paragraph (2) applies where the permitted price given by Paragraph (b) of paragraph 2 on day ("the first day") would be different from the permitted price on the next day ("the second

ANNEXES continued ...

day”) as a result of a change to the rate of duty or value added tax.

(2) The permitted price which would apply on the first day applies to sales or supplies of alcohol which take place before the expiry of the period of 14 days beginning on the second day.

Exhibition of films

- (1) Where a Premises Licence authorises the exhibition of films, the licence must include a condition requiring the admission of children to the exhibition of any film to be restricted in accordance with this section;
- (2) Where a film classification body is specified in the licence, unless subsection (3)(b) applies, admission of children must be restricted in accordance with any recommendation made by that body;

(3) Where:

- (a) The film classification body is not specified in the Licence, or
- (b) The relevant licensing authority has notified the holder of the licence that this subsection applies to the film in question,

admission of children must be restricted in accordance with any recommendation made by the Licensing Authority.

(4) In this section-

“children” means persons aged under 18; and

“film classification body” means the person or persons designated as the authority under section 4 of the Video Recordings Act 1984 (c.39) (authority to determine suitability of video works for classification).

ANNEX 2 - CONDITIONS CONSISTENT WITH THE OPERATING SCHEDULE

A 30 minute drinking up time on top of the last permitted sale of alcohol to allow customers to use the toilet facilities and disperse from the premises.

ANNEXES continued ...

Locations of fire safety and other safety equipment subject to change in accordance with the requirements of the responsible authorities or following a risk assessment.

Any detail shown on the plan that is not required by the Licensing plans regulations is indicative only and subject to change at any time.

PREVENTION OF CRIME AND DISORDER

- The licensee shall ensure that an effective Closed Circuit Television (CCTV) surveillance system that records in real time covering licensable areas all exits/areas front forecourt grounds, and any areas where the public have access shall be maintained. Recording shall be retained for thirty days A member of staff will always be on duty that is able.
- A suitably worded sign of sufficient size and clarity shall be displayed at the point of entry to the premises, and in a suitable location at the point of sale, advising customers that CCTV is operating in the premises.
- **The DPS shall be responsible for ensuring that staff complete challenge 25 training and training in relation to the licensing law including the sale of alcohol to people who are drunk before making any sales of alcohol.**
- Written records of staff training shall be retained on the premises and made available to the Police/Licensing Authority upon reasonable request.
- An incident book shall be retained on the premises to record all incidents. The book shall be made available to the Police/Licensing Authority upon reasonable request.
- A refusals book shall be retained behind each bar on the premises to record refusals of sales of alcohol. The book shall be made available to the Police/Licensing Authority upon reasonable request.
- The premises licence holder will risk assess the need for SIA door supervisors at the premises and/or employ such door supervisors at such time and in such numbers as deemed necessary by the risk assessment and/or at any other times the Police (Inspector or above) request. Where door staff are utilised at the premises, the Licensee shall ensure that a proper record is kept to show full details of all door staff on duty.
- The Car Park and rear garden area will be well lit at all times when licensable activities are taking place.
- The licensee shall within three months from the date of the grant create a scheme of written policies in agreement with police which will include:

Dispersal Policy

Drugs Policy to include regular toilet checks.

Noise Policy

Glassware Risk Assessment - The Licensee shall undertake (and from time to time review) an assessment of the risks to persons arising from the use of glass drinking vessels (not including drinks served in bottles) as potential weapons. Where an assessment shows a significant risk, the licensee shall ensure that only non-glass drinking vessels are used.

Scoring Matrix - The licensee shall formulate and comply with a policy document governing use of the venue for functions at the premises. The policy document shall specify how the licensed area will be used and shall make provision for required documentation to be created in relation to any event to specifically include, but not be limited to:-

- A Scoring Matrix to assess risk.
- Measures implemented in response to the Scoring Matrix
- The circumstances in which there will be notification of the function to the Licensing Authority and Police.
- The content of such notification.
- The retention period of required documentation (subject to a minimum of 12 months).
- The provision of required documentation to the Police and Licensing Authority upon request.
- The management of functions predominantly for persons under 18 years of age.

PUBLIC SAFETY

Staff will be trained in all legislation relevant to their job role.

PREVENTION OF PUBLIC NUISANCE

Notices will be displayed asking customers to leave the premises quietly and respect neighbours.

Doors and windows will remain closed (except for access to and egress from the premises) after 22:00hrs during any regulated entertainment.

PROTECTION OF CHILDREN FROM HARM

Children will be accompanied by an adult.

The Challenge 25 scheme shall be adopted at the premises, whereby anyone who appears to be under the age of 25 shall be asked for identification to prove that they are over 18 years old. The only acceptable forms of ID are passports, UK photocard driving licences and "PASS" logo accredited proof of age cards.

A 30 minute drinking up time on top of the last permitted sale of alcohol to allow customers to use the toilet facilities and disperse from the premises.

ANNEXES continued ...

Locations of fire safety and other safety equipment subject to change in accordance with the requirements of the responsible authorities or following a risk assessment.

Any detail shown on the plan that is not required by the Licensing plans regulations is indicative only and subject to change at any time.

ANNEX 3 - CONDITIONS ATTACHED AFTER A HEARING BY THE LICENSING AUTHORITY

Hearing 19/8/2016

- 1) Essex Police conditions added at Annex 2 as requested.
- 2) Garden area to be restricted to permitted activities during the hours of 11am to 6pm as below:
 - Sale of alcohol
 - Performance of live music
 - Playing of recorded music
 - Performance of dance

Hearing 24/6/2019

- 1) Sale of alcohol in the garden until 21.30 May to September only - all other months until 18.00.
- 2) An emergency contact number for the Duty Manager must be displayed in a prominent position on the outside of the premises.

Designated Licensing Officer



LOCAL AUTHORITY



Licensing Department
Castle Point Borough Council
 Council Offices, Kiln Road,
 Thundersley, Benfleet,
 Essex SS7 1TF
 Tel: 01268 882200

Premises Details

POSTAL ADDRESS OF PREMISES, OR IF NONE, ORDNANCE SURVEY MAP REFERENCE OR DESCRIPTION

BREAD AND CHEESE

520 LONDON ROAD, BENFLEET, ESSEX, SS7 1AA.

Telephone 01268 753402 or 07979 187558 (Kate)

WHERE THE LICENCE IS TIME LIMITED THE DATES

Not applicable

LICENSABLE ACTIVITIES AUTHORISED BY THE LICENCE

- an exhibition of a film
- a performance of live music
- any playing of recorded music
- a performance of dance
- entertainment facilities for making music
- entertainment facilities for dancing
- entertainment of a similar description to that falling within entertainment facilities for making music or dancing
- provision of late night refreshment
- the sale by retail of alcohol

THE TIMES THE LICENCE AUTHORISES THE CARRYING OUT OF LICENSABLE ACTIVITIES

Activity (and Area if applicable)	Description	Time From	Time To
B. Exhibition of films (Indoors)	Monday to Thursday	11:00am	11:30pm
	Friday and Saturday	11:00am	1:00am
	Sunday	11:00am	11:00pm
	Bank Holiday	12:00pm	12:30am
	Christmas Day	11:00am	12:30am
	Boxing Day	11:00am	12:30am
	New Years Eve	11:00am	3:30am
E. Performance of live music (Indoors & Outdoors)	Bank Holiday	8:00pm	11:00pm
	Sunday	11:00am	11:00pm
	Monday to Thursday	11:00am	11:30pm
	Christmas Eve	8:00pm	Midnight
	Boxing Day	8:00pm	Midnight
	Friday and Saturday	11:00am	1:00am
	New Years Eve	8:00pm	2:00am



Premises Licence Summary

THE TIMES THE LICENCE AUTHORISES THE CARRYING OUT OF LICENSABLE ACTIVITIES continued ...

Activity (and Area if applicable)	Description	Time From	Time To
E. Performance of live music (Indoors & Outdoors) continued ...	Monday to Sunday Garden	11:00am	11:00pm
F. Playing of recorded music (Indoors & Outdoors)	Sunday Indoors	11:00am	11:00pm
	Bank Holiday Indoors	8:00pm	11:00pm
	Christmas Eve Indoors	8:00pm	Midnight
	Monday to Thursday Indoors	11:00am	11:30pm
	Friday and Saturday Indoors	11:00am	1:00am
	Boxing Day Indoors	8:00pm	Midnight
	New Years Eve Indoors	8:00pm	2:00am
	Monday to Sunday Garden	11:00am	11:00pm
G. Performance of dance (Indoors & Outdoors)	Sunday Indoors	11:00am	11:00pm
	Bank Holiday Indoors	8:00pm	11:00pm
	Christmas Eve Indoors	8:00pm	Midnight
	Monday to Thursday Indoors	11:00am	11:30pm
	Friday and Saturday Indoors	11:00am	1:00am
	Boxing Day Indoors	8:00pm	Midnight
	New Years Eve Indoors	8:00pm	2:00am
	Monday to Sunday Garden	11:00am	11:00pm
I. Provision of facilities for making music (Indoors & Outdoors)	Sunday Indoors	11:00am	11:00pm
	Bank Holiday Indoors	8:00pm	11:00pm
	Christmas Eve Indoors	8:00pm	Midnight
	Monday to Thursday Indoors	11:00am	11:30pm
	Friday and Saturday Indoors	11:00am	1:00am
	Boxing Day Indoors	8:00pm	Midnight
	New Years Eve Indoors	8:00pm	2:00am
	Monday to Sunday	11:00am	11:00pm



Premises Licence Summary

THE TIMES THE LICENCE AUTHORISES THE CARRYING OUT OF LICENSABLE ACTIVITIES continued ...

Activity (and Area if applicable)	Description	Time From	Time To
I. Provision of facilities for making music (Indoors & Outdoors) continued ...			
	Garden		
J. Provision of facilities for dancing (Indoors & Outdoors)			
	Sunday	11:00am	11:00pm
	Indoors		
	Bank Holiday	8:00pm	11:00pm
	Indoors		
	Christmas Eve	8:00pm	Midnight
	Indoors		
	Monday to Thursday	11:00am	11:30pm
	Indoors		
	Friday and Saturday	11:00am	1:00am
	Indoors		
	Boxing Day	8:00pm	Midnight
	Indoors		
	New Years Eve	8:00pm	2:00am
	Indoors		
	Monday to Sunday	11:00am	11:00pm
K. Provision of facilities for entertainment of a similar description to that falling within I or J (Indoors)			
	Friday and Saturday	11:00am	1:00am
	Thursday	8:00pm	11:00pm
	Christmas Eve	8:00pm	Midnight
	Boxing Day	8:00pm	Midnight
	New Years Eve	8:00pm	2:00am
	Bank Holiday	8:00pm	11:00pm
	Monday to Sunday	11:00am	11:00pm
	Garden		
L. Late night refreshment (Indoors)			
	Monday to Thursday	11:00pm	11:30pm
	Friday and Saturday	11:00pm	1:00am
	Monday to Sunday	11:00am	11:00pm
	Garden		
M. The sale by retail of alcohol for consumption ON and OFF the premises			
	Monday to Thursday	11:00am	11:00pm
	Bank Holiday	Noon	Midnight
	Monday to Sunday	11:00am	9:30pm
	Garden (21.30 May to September only - All other months	18:00)	
	Friday and Saturday	11:00am	12:30am
	Sunday	11:00am	11:00pm
	Christmas Eve	11:00am	Midnight
	Boxing Day	11:00am	Midnight
	New Years Eve	11:00am	3:00am



Premises Licence Summary

THE OPENING HOURS OF THE PREMISES

Description	Time From	Time To
Monday to Thursday	11:00am	11:30pm
Friday and Saturday	11:00am	1:00am
Sunday	11:00am	11:00pm
Bank Holiday	Noon	12:30am
Christmas Day	11:00am	12:30am
Boxing Day	11:00am	12:30am
New Years Eve	11:00am	3:30am

WHERE THE LICENCE AUTHORISES SUPPLIES OF ALCOHOL WHETHER THESE ARE ON AND / OR OFF SUPPLIES

- M. The sale by retail of alcohol for consumption ON and OFF the premises

NAME, (REGISTERED) ADDRESS OF HOLDER OF PREMISES LICENCE

BREAD AND CHEESE (BENFLEET) LTD

304 HIGH ROAD, BENFLEET, ESSEX, SS7 5HB.

REGISTERED NUMBER OF HOLDER, FOR EXAMPLE COMPANY NUMBER, CHARITY NUMBER (WHERE APPLICABLE)**NAME OF DESIGNATED PREMISES SUPERVISOR WHERE THE PREMISES LICENCE AUTHORISES THE SUPPLY OF ALCOHOL**

JOANNE HASLAM

STATE WHETHER ACCESS TO THE PREMISES BY CHILDREN IS RESTRICTED OR PROHIBITED

CHILDREN ARE NOT RESTRICTED OR PROHIBITED FROM ACCESS TO THE PREMISES

Designated Licensing Officer



Appendix 3

Case Reference:	24/00309/LICPRE
Address:	Bread and Cheese – 520 London Road, Benfleet, SS7 1AA
Case Officer:	Laura Hemsworth (<i>Senior Environmental Health Officer</i>) 01268 882390 lhemsworth@castlepoint.gov.uk
Date:	30 th April 2024
Current licence:	Annex 3 to the current licence applies some conditions following two hearings: <ul style="list-style-type: none"> - The hearing in 2016 resulted in a condition being applied restricting the garden area to be used for permitted activities during the hours of 11am-6pm for the sale of alcohol, performance of live music, playing of recorded music and performance of dance. - The hearing in 2019 then resulted in the sale of alcohol in the garden beings restricted to 9.30pm between May-September and until 6pm in other months.
Summary of application:	The Bread and Cheese pub located in Benfleet has recently submitted an application to vary their licence. They wish to: <ul style="list-style-type: none"> - Open earlier - Use the outside area for permitted activities from April-September between the hours of 10am and 9.30pm (to include live music, recorded music, dance and films). And between the hours of 10am and 6pm during October-March.

Representation from Environmental Health

Environmental Health would like to object to the variation of this licence due to concerns relating to the use of the garden for permitted activities (sale of alcohol, performance of live music, playing of recorded music and performance of dance). Please find the reasonings for this outlined below:

Relevant history

Environmental Health has a history of noise complaints regarding this premises dating back a number of years. Prior to the 2016 hearing, complaints were received regarding a once a month Soul Night which took place inside the premises. These complaints were substantiated, and the complainants were found to be disturbed when trying to sleep. As a result, Environmental Health worked with the pub owners at the time who undertook considerable sound proofing works to the pub which resolved the matter.

However, the 2016 hearing took place after the premises applied to make various changes to the licence including using the garden for permitted activities between the hours of 11am to 10pm. Environmental Health gave representations at this hearing and explained that, whilst they acknowledged the applicants efforts to make improvements inside, if the garden was to be used for permitted activities this would result in a rise in noise levels which will impact local residents. The hearing concluded that the garden would only be used for permitted activities during the hours of

11am-6pm (sale of alcohol, performance of live music, playing of recorded music and performance of dance).

Further complaints then were received in 2017/18 during Temporary Event Notice events in the garden. Monitoring was undertaken by Environmental Health and the Team Leader at the time, Mr S. Grant, stated that although the noise levels were borderline/unacceptable, due to the lack of frequency of events and operation under the TEN application procedure, no further action was deemed necessary. However, if the occurrences were more regular or to later times in the evening, there would be a nuisance to residents and enforcement action would be necessary.

In 2019, the premises then applied to make changes to the licence to again use the garden for permitted activities until much later than 6pm. Environmental Health objected to this variation for the above stated reasons by Mr Grant – if the occurrences of noise from events held in the garden were to become more frequent and until later times, there would likely be a nuisance to residents nearby. At this hearing, 11 representations were heard from people living nearby. They explained that some outdoor events held by the pub were ‘unbearable’ in terms of noise and that they were concerned that the excessive noise levels could have an impact on their health including stress, high blood pressure and heart attacks. The hearing concluded that the conditions added during the 2016 hearing regarding the garden use for permitted activities remained the same.

After the 2019 hearing, Environmental Health received another complaint about disturbance caused by the live music in the garden area. The complainant was provided with access the Noise App (for recording occurrences of disturbance) and the evidence they supplied meant that Environmental Health served an abatement notice based on the ‘likely occurrence’ of a statutory nuisance to reiterate the hours stated in Annex 3 to the licence: ‘restrict the use of the garden for permitted activities (sale of alcohol, performance of live music, playing of recorded music and performance of dance) to during hours of 11am to 6pm and restrict the use of the garden for sale of alcohol to during the hours of 11am to 9.30pm May to Sept’.

Current Representation

As previously stated, Environmental Health would like to object to this current licence variation. The history described above shows that we have previously objected to similar licence variations and our reasons for doing so remain the same as now. Most importantly it must be highlighted that it is not possible to carry out sound proofing works to the garden. Any live music, performances, recorded music, films etc held in the garden will likely to be heard by nearby residents causing them disturbance due to the close proximity of the premises to houses in the area.

The above case history also advises that Environmental Health served abatement notices under the Environmental Protection Act for ‘likely occurrence’ of a statutory nuisance. The investigation of noise complaints is a duty which the team must undertake. In addition, if a statutory nuisance is found, the legislation states that action must be taken.

To clarify what ‘nuisance’ means in terms of its use under this Act – it is a significant and unreasonable emission of noise etc, which causes significant and unreasonable interference with the use and enjoyment of your home. It does not include noise etc from every-day activities. It is greater than ‘annoyance’ and is much greater than detection of a noise. The nuisance law applies to ‘the everyday reasonable person’ and cannot cater for people with a specific sensitivity to noise or special circumstances.

It is also necessary to highlight that not all the complainants for the previous noise complaints live directly next to the premises. Some live quite a significant distance away which emphasises the impact that loud music/other noise in an outdoor area can have on local residents.

The Chartered Institute of Environmental Health (CIEH) is always looking to raise the profile of how noise can have an impact on public health. Noise has a significant impact on people's health, wellbeing and quality of life. It has been linked to increasing the risk of cardiovascular disease and potential other cardiometabolic diseases including strokes and diabetes. The CIEH Noise Survey completed regularly provides valuable evidence that noise can profoundly and adversely impact people's quality of life, productivity, and peaceful enjoyment of their homes. For this reason, it is vital that Environmental Health raises this objection.

Although the current licence permits the premises to use the garden for permitted activities until 6pm (sale of alcohol, performance of live music, playing of recorded music and performance of dance), Environmental Health is of the opinion that the garden should not be used for these activities at all (including the use of an outside tv screen).

The garden cannot be made soundproof and taking into consideration the close proximity of its location to nearby residents and the history described in this report, Environmental Health believes that it is extremely likely that granting this application will result in residents experiencing a noise nuisance which will make them at risk of the health effects described above.

Although Environmental Health always works to support businesses in the Borough, we are also here to ensure that public health is not affected by nuisance. The summer months should be when families spend time in their gardens enjoying the warmer weather or be able to have their windows and doors open until later into the evening. They should not be subjected to noise nuisance from a nearby pub garden when just trying to enjoy normal everyday activities in their own home.

Granting this licence application will give the premises the opportunity to use the outside area every day, potentially up to 9.30pm, for activities which will likely cause a nuisance. This would not be acceptable to residents living in the area and puts them at risk of the health effects created by noise nuisance. Young children often go to bed much earlier than 9.30pm and it can be exhausting for parents, as well as the children, if noisy events prevent this. If this occurs week after week, Environmental Health has no doubt that the impact on health would be significant.

Finally, it must be remembered that the 2019 hearing had 11 representations made by local residents with a spokesperson describing noise from previous outside events as 'unbearable'. If this licence application is granted, it is likely that these residents will experience this again.

For the above stated reasons, Environmental Health has no other option but to raise this objection and bring it to the attention of the Licensing Committee for their decision.

REPRESENTATION of RESIDENT – ANDREW BROWN

To Whom it may concern.

For 28 years I have lived here, and the worse thing I have ever had to put up with is the Bread & Cheese pub, With Music, shouting, swearing and cars up to 1am plus. I have had drunks urinating on my van, throwing bottles and being obnoxious outside my house.

Plus what would make you think for a minute that any of the residents of Thundersley Grove or Mount Road would want to kept up until the early hours of the morning with loud music. The previous owner also done the same, moving the music from the rear of the pub to the front, and on so many occasions leaving the doors open because it was too hot. I have lost count with the number of times I had to go over there and ask them to turn it down and shut the doors.

And my wife and I having to try and sleep in the middle of summer with the windows closed.

I honestly think you have given no consideration for the people that have to live in and around the proximity of this pub and am absolutely disgusted that you would be happy to take their money for a entertainment license, Why can it not just be a place to eat and take your family as this is really lacking from this area, not some loud venue, and I am absolutely sure none of you live near this pub and have to put up with the Music, shouting for a single minute.

Surely as a council your first priority is the residents, I understand that Castle point has sold more Green belt land than any other council so maybe your drive for money is far greater than the peace and quiet that is my right to enjoy and not be forced to listen to loud music, every weekend.

Please for once in your life, think about the environment, wildlife and the health and care of the residents within the proximity of this pub.

Andrew Brown. EngTech TMIET

